

**LuxR** LED BY DESIGN



# MODUX SERIES

Contemporary modular light fixtures powered by the LuxR™ light engine



## MODUX SERIES

- Advanced lighting, designed by experienced lighting specialists
- Ultra efficient LED light engine with industry leading Cree™ LEDs
- Plug-in LED board for simple upgrade or replacement
- Modular construction for easy maintenance
- LEDShield series wiring electronic protection bypasses non-functioning LEDs
- CoolTouch engineering means the luminaire will never be too hot to touch
- Integral driver option for Modux 2 & Modux 4 to compliment 12 V AC magnetic transformer systems
- IP68 fully waterproof to 1 bar (10m) rating on the majority of products
- Dimmable
- UL1838 accreditation for North America
- Designed and manufactured in New Zealand
- Confidence body warranty of ten years
- Confidence electronics warranty of five years

All specifications outlined in this catalogue superceed any specifications described in any previously published catalogue.

# MODULAR CONSTRUCTION



CoolTouch  
Safe operating temperature

Interchangeable optics

Interchangeable LED module

LEDShield  
Series failure protection

Removable integral driver module (optional)





# MODUX MICRO

## Finishes

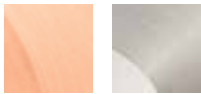

Natural Copper      316 Stainless Steel

## LED Colours

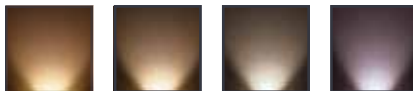

Warm White 2700K    Warm White 3000K    Neutral White 4000K    Cool White 5000K

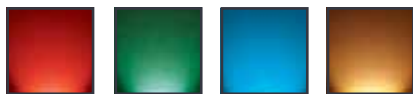

Red      Green      Blue      Amber

## Beam



16°      37°      84°      Oval 18°+48°      Diamond & Marker



The Modux Micro range are among the world's smallest range of landscape luminaires available today. The reliability and convenience of the larger Modux One is shared in this range of miniature versions. Ingress rated to IP68. Powered by the 1 watt LuxR™ light engine these luminaires can also be under-driven with as little as 50mA.

Specifications	
Power:	1 Watt
Input Current:	< 350mA
Forward Voltage:	≈ 3V
CRI:	Ra 82
Luminaire Efficacy:	64 Lm/W @ 350mA
Luminaire Options:	Spot spike, Diamond 360° spike , Diamond 180° spike , round recessed Marker
Standards:	IP68, LM79, CE, UL1838
Light Engine:	Plug-in dimmable module equipped with the Cree® XT-E LED
Driver:	External constant current driver required, 350mA or less.

# MODUX MICRO MARKER+SPOT

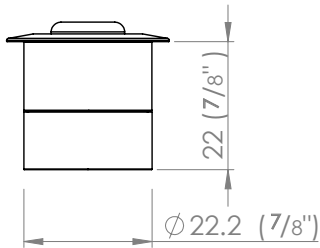

Modux Micro Marker , Stainless steel

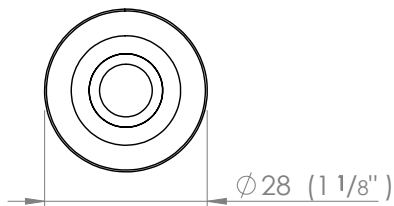

Modux Micro Marker , Copper



Modux Micro Spot, Copper



Modux Micro Spot, Stainless steel

The recessed Marker creates a low illumination to mark boundaries and edges. Ideal for timber decking installation.

Accessories:

- 350mA constant current remote driver
- Marker PVC canister tube



The Modux Micro ground spikes are particularly easy to install. Simply push into the soil and orient as required. Additionally a shallow trench will easily conceal the cabling if desired.

# DIAMOND 180°+DIAMOND 360°



Modux Micro Diamond 360°, Copper



Modux Micro Diamond 180°, Stainless steel

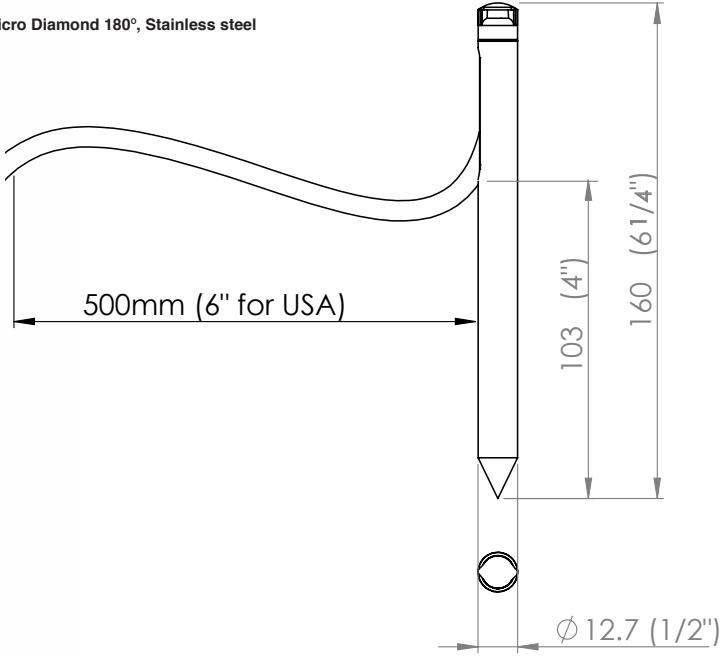

The Modux Micro Diamond projects light slightly upward from horizontal to illuminate the underside of foliage.

The Modux Micro Diamond 180 has a 50% aperture to project light back up into foliage and box hedges without glare, illuminating pathways and viewpoints.

Accessories:

- 350mA constant current remote driver



## ORDERING

# MODUX MICRO CONFIGURATOR

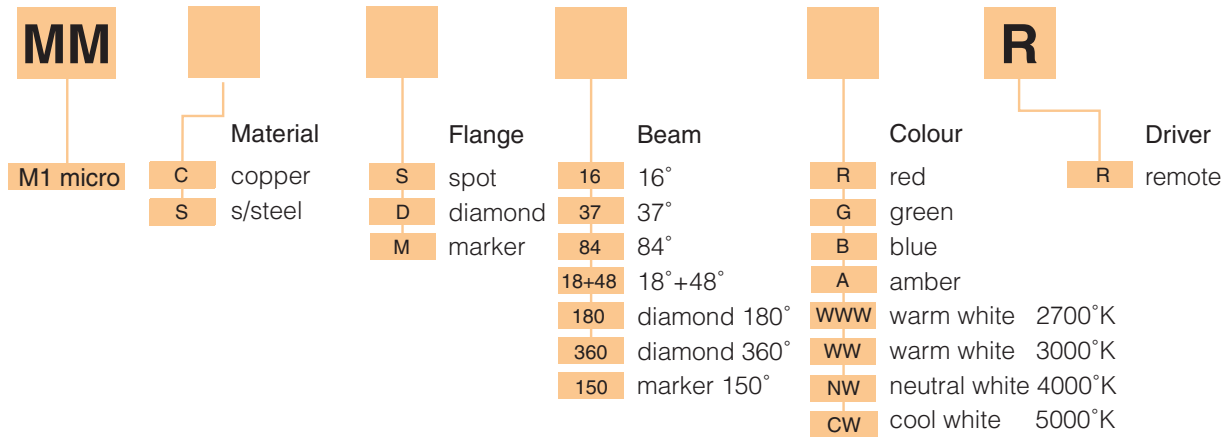

---

---

---

---

---

---

---

---

---

---

## CONFIGURATOR WORKED EXAMPLE

**MM** **S** **S** **16** **WW** **R**

e.g. Modux Micro . Stainless steel . Spot flange . 16° beam . 3000°K . Remote driver .





# MODUX ONE

## Finishes



Natural Copper



316 Stainless Steel



Black Powdercoated Passivated Aluminium

## Lens Cover



Clear



Frosted

## LED Colours



Warm White  
2700°K



Warm White  
3000°K



Neutral White  
4000°K



Cool White  
5000°K



Red



Green



Blue



Amber

## Beam



10°



15°



20°



30°



The Modux One is a range of very compact, contemporary LED luminaires powered by a 1 Watt LuxR™ light engine. The modular design was developed to meet the challenge of delivering high quality practical accent lighting with maximum energy efficiency and a long, maintenance free life.

Specifications	
Power:	1 Watt
Input Current:	350mA
Forward Voltage:	≈ 3V
CRI:	Ra 82
Luminaire Efficacy:	72 Lm/W @ 350mA
Luminaire Options:	Round recessed, Square recessed, Pond, Spot, Spike
Standards:	IP68, LM79, CE, UL1838
Light Engine:	Plug-in dimmable module equipped with the Cree® XT-E LED
Driver:	External constant current driver required, 350mA or less.

# MODUX ONE

## ROUND+SQUARE RECESSED



Modux One Round, Stainless steel

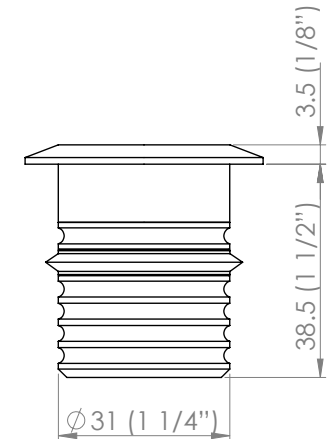
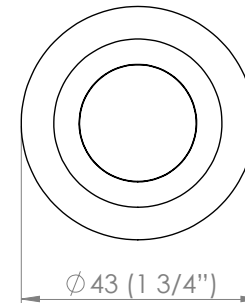

Modux One Square, Stainless steel

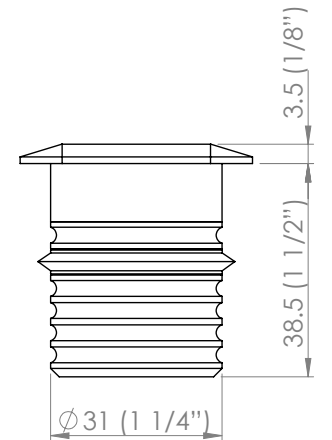
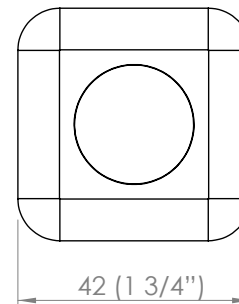

The Modux One recessed luminaires are designed to be mounted either in the ground/floor as low profile uplighters, or in walls or steps to illuminate paths

and stairways. Suitable for outdoor and indoor installation.

Accessories:

- PVC Mounting canister
- 350mA constant current remote driver



SPOT+WEIGHTY BASE+BRACKET+SPIKE



Modux One spot on a weighty base, Stainless steel

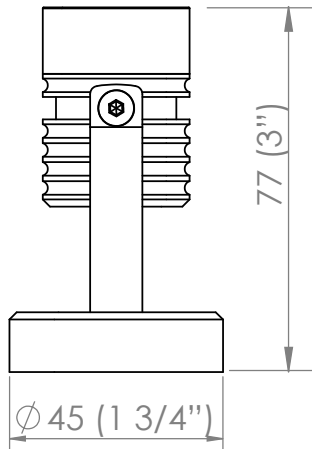

Modux One Spot on a bracket, Stainless steel

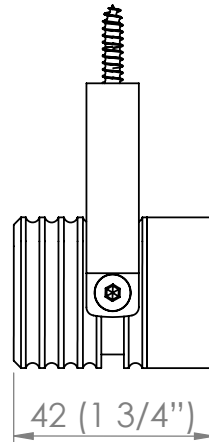

Modux One spot on a Spike, Stainless steel

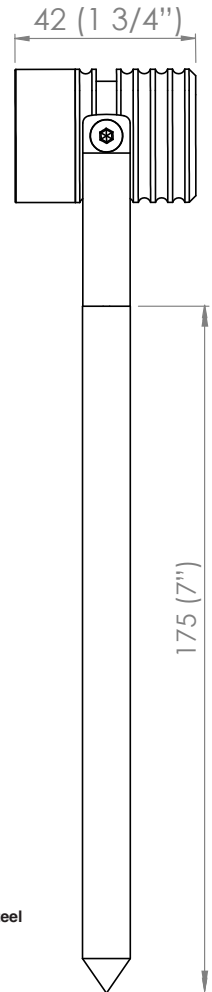

The Modux One Pond, Spot and Spike luminaires are miniature spotlights with a swivel bracket that provides for 90° of elevation adjustment. The Pondlight has a weighty solid base and is designed to

be installed underwater. The Spot can be mounted to any solid surface and the Spike is designed to be inserted directly into the ground.

Accessories:

- 350mA constant current remote driver



# MODUX ONE WAYFINDER



Modux One Wayfinder, Copper



Modux One Wayfinder, Copper, Stainless, Aluminium

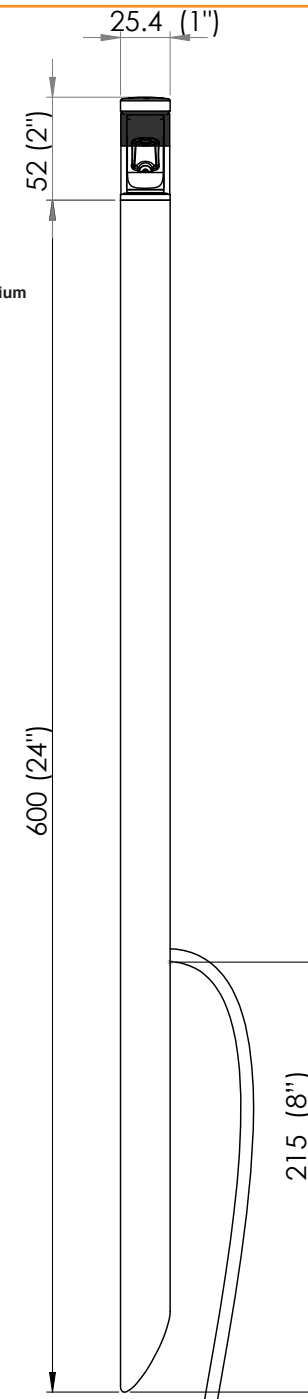

This one inch diameter miniature pole light produces plenty of light in an asymmetric wash, without glare.

Precision machined in marine grade 316 stainless steel, copper or powdercoated aluminium, the luminaire achieves IP68 water ingress rating for peace of mind.

The Cree 1 Watt max LED can be easily replaced if required or substituted for a colour LED.

Accessories:

- 12VAC, 12-24VDC integrated driver (Q1 release 2016)
- 240VAC integrated driver (Q1 release 2016)
- 350mA remote driver





# MODUX ONE CONFIGURATOR

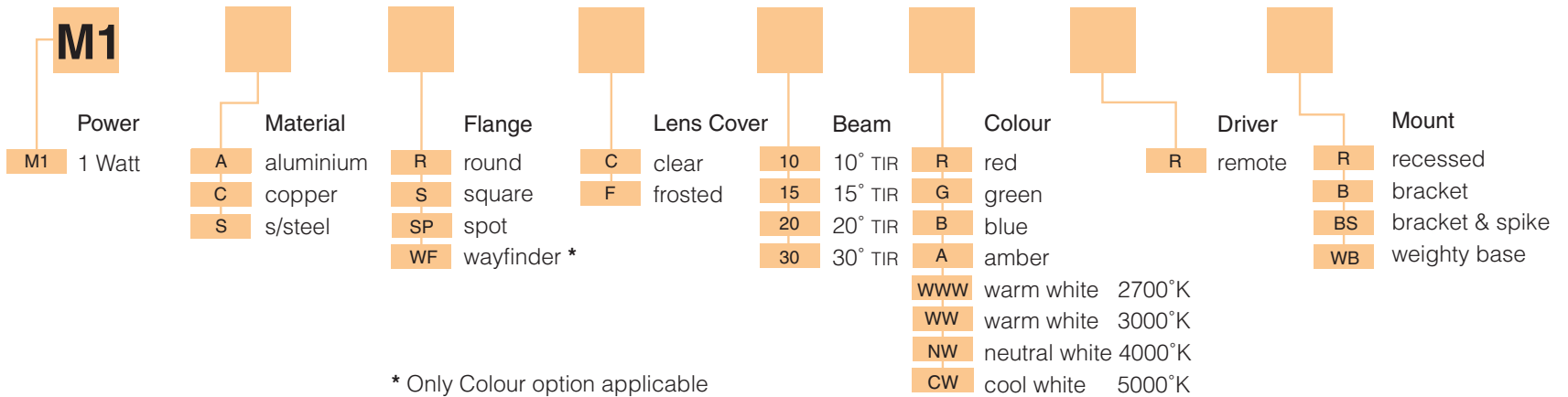

---



---



---



---



---



---



---



---

## CONFIGURATOR WORKED EXAMPLE

**M1**   **S**   **SP**   **C**   **10**   **WW**   **R**   **BS**

e.g. Modux One . Stainless steel . Spot flange . Clear lens, 10° beam . 3000°K . Remote driver . Bracket + spike

# MODUX TWO

## Finishes

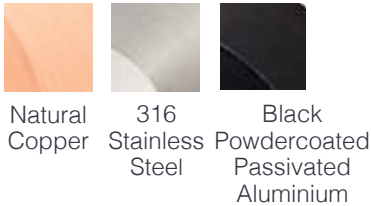

## Lens Cover



## LED Colours

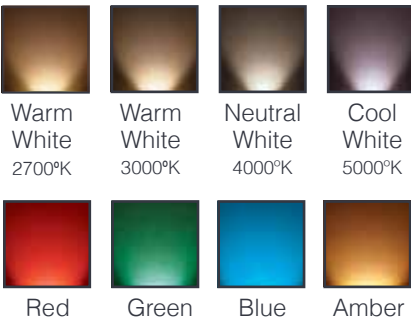

## Beam

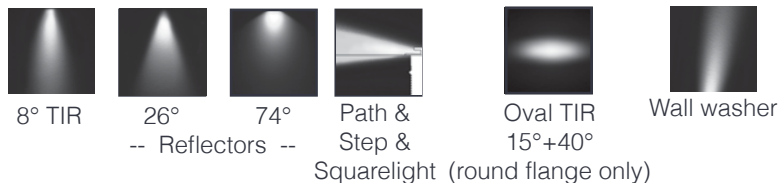

Modux Two is a range of mid-size, contemporary LED luminaires powered by a 2 watt LuxR™ light engine that offers a wide choice of LED colours. The modular design was developed to meet the challenge of delivering high quality practical accent lighting with maximum energy efficiency and a long, maintenance-free life.

Specifications	
Power:	2 Watt
Input Current:	700mA
Forward Voltage:	≈ 3V
CRI:	Ra 82
Luminaire Efficacy:	66 Lm/W @ 700mA
Luminaire Options:	Round recessed , Square recessed , Louvre recessed , Path recessed , Step recessed , Pond , Spot , Spike Spot, Wall washer recessed, Squarelight recessed, Large Square/Louvre/Round.
Standards:	IP68, LM79, CE, UL1838
Light Engine:	Plug-in dimmable module equipped with the Cree® XT-E LED
Driver:	integral 12VAC driver or external remote driver. Note: Luminaire consumes approximately 3.2W with 700mA integral driver, and 5.6W with 1100mA integral driver.

# WALL WASHER (MKII)

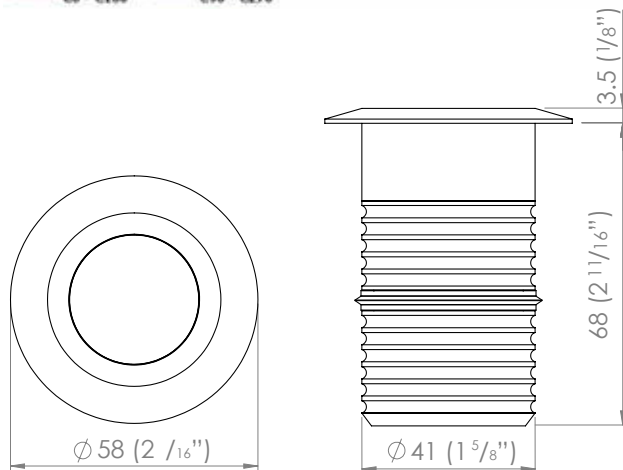
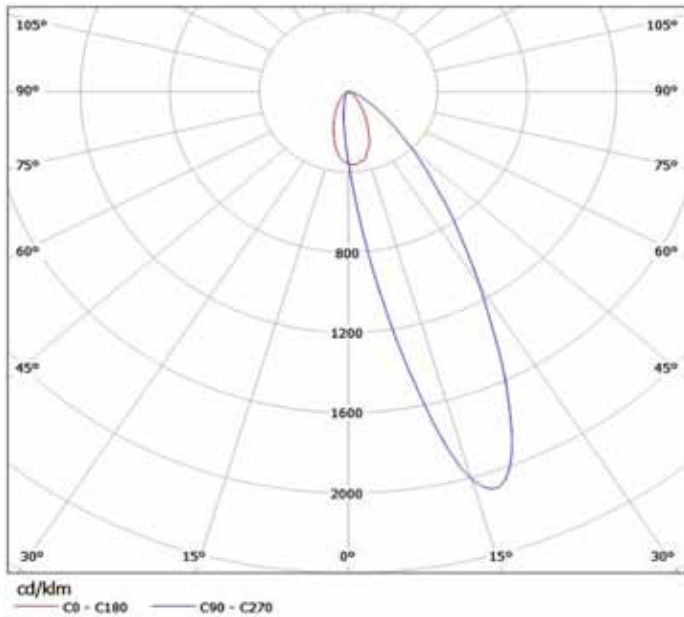

Modux Two Wall Washer, Stainless steel

The Modux Two Wall Washer features a precision rectangular wall-washing optic with excellent vertical beam uniformity. The asymmetrically tilted beam ensures uniform illumination on vertical surfaces.

Suitable for Modux 2 Round flange only.

Accessories:

- 50mm diameter PVC mounting canister
- 700mA or 1050mA constant current remote driver

- Plug-In 12 Volt AC integral driver, 700mA max



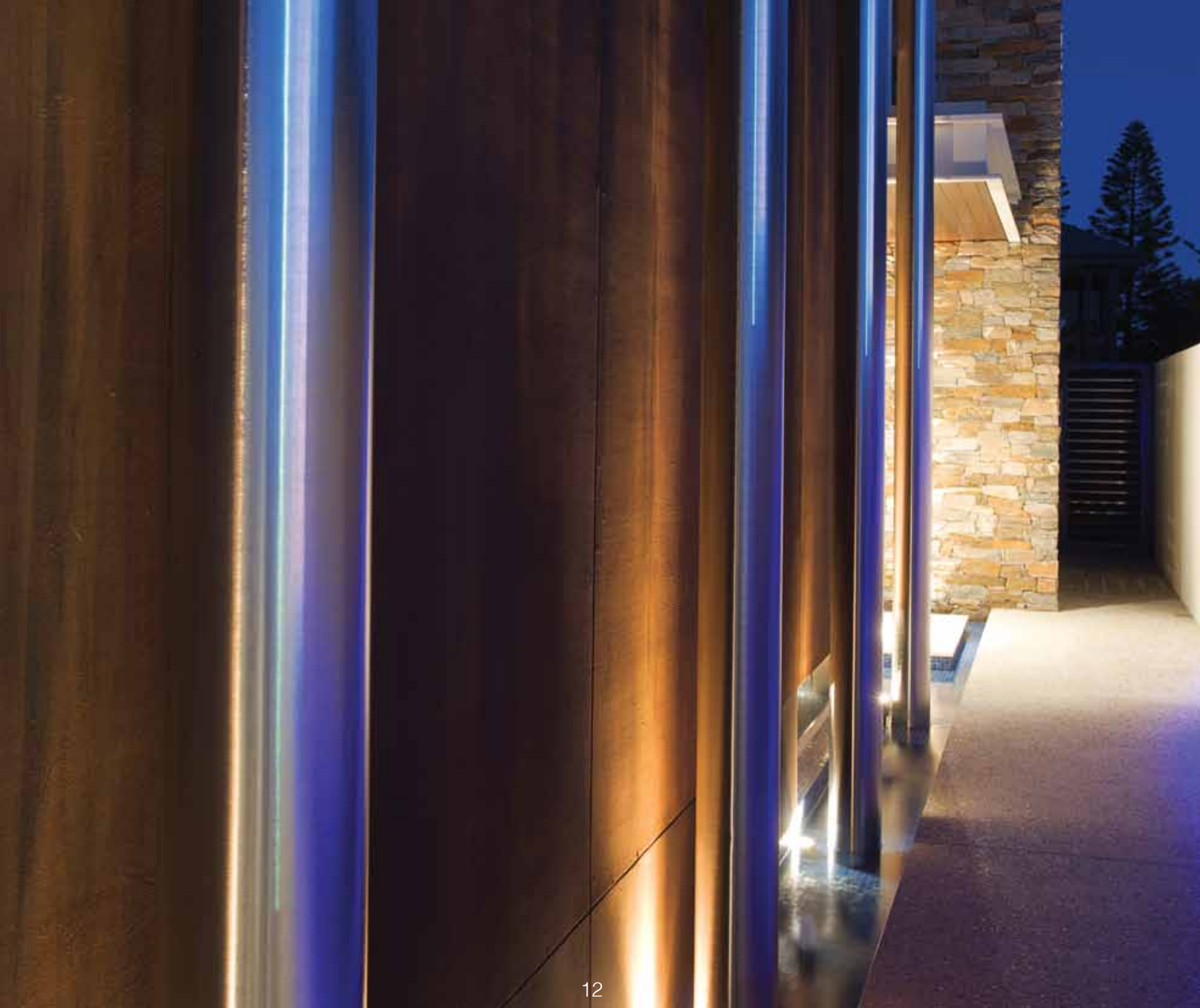



# MODUX FOUR

## Finishes

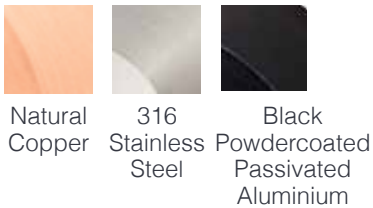

## Lens Cover



## LED Colours

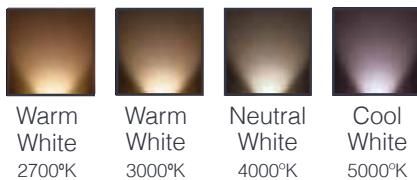

## Beam

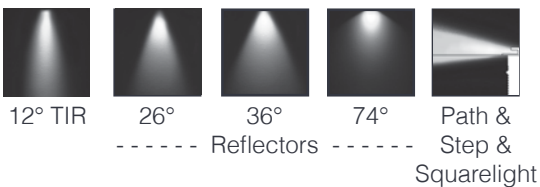

Modux Four is a range of mid-size, contemporary LED luminaires powered by a 4 watt LuxR™ light engine that offers white colours only. The modular design was developed to meet the challenge of delivering high quality practical accent lighting with maximum energy efficiency and a long maintenance free life.

Specifications	
Power:	4 Watt
Input Current:	700mA
Forward Voltage:	≈ 6V
CRI:	Ra 83
Luminaire Efficacy:	83 Lm/W @ 700mA
Luminaire Options:	Round recessed , Square recessed , Louvre recessed , Path recessed , Step recessed , Pond , Spot , Spike Spot, Squarelight recessed, Large Square/Louvre/Round.
Standards:	IP68, LM79, CE, UL1838
Light Engine:	Plug-in dimmable module equipped with the Cree® MTG LED
Driver:	Integral 12V AC driver or external remote driver. Note: Luminaire consumes approximately 5.2W with 700mA integral driver.

# MODUX TWO & FOUR

## ROUND RECESSED



Modux Two & Four Round, Stainless Steel

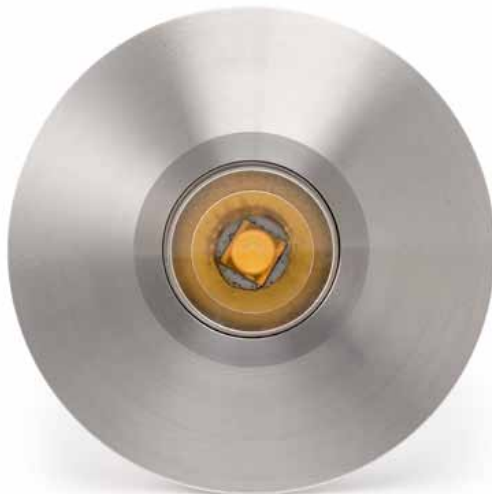
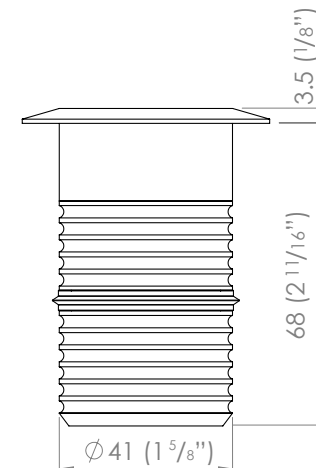
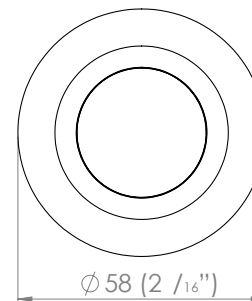

Modux Two & Four Large Round, Stainless Steel

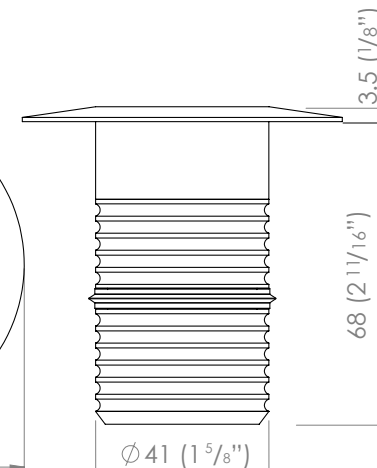
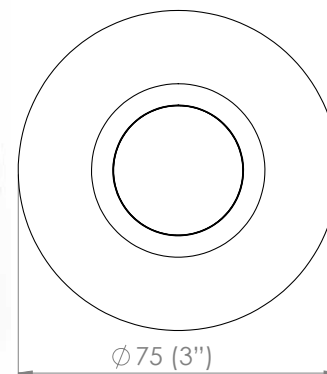

The Modux Two & Four recessed luminaires are designed to be mounted either in the ground/floor as low profile uplighters, or in walls or steps to illuminate paths and stairways.

Now available in a larger format flange style to better cover difficult mounting scenarios.

Accessories:

- 50mm diameter PVC mounting canister

- 700mA constant current remote driver
- Plug-In 12 Volt AC integral driver
- Hexcell louvre available



# MODUX TWO & FOUR SQUARE RECESSED



Modux Two & Four Square, Stainless Steel

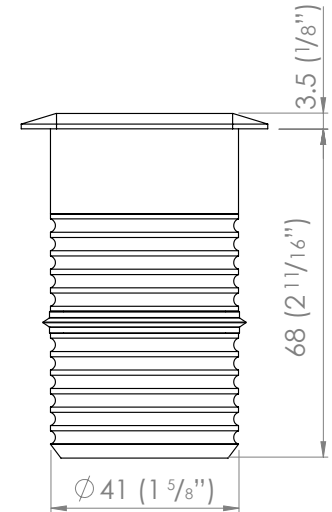
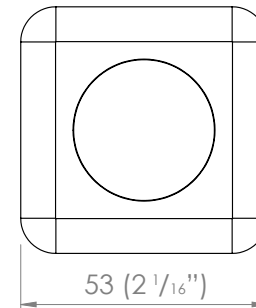

Modux Two & Four Large Square, Stainless Steel

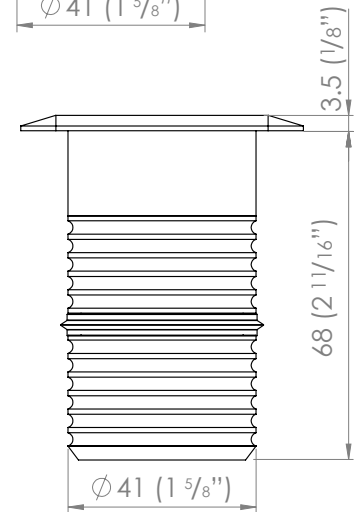
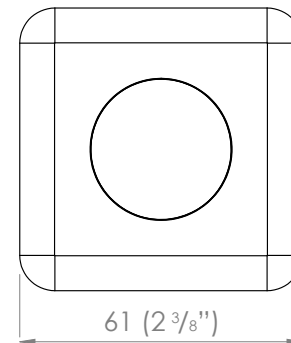

The Modux Two & Four recessed luminaires are designed to be mounted either in the ground or floor as low profile uplighters, or in walls or steps to illuminate paths and stairways.

Now available in a larger format flange style to better cover difficult mounting scenarios.

Accessories:

- 50mm diameter PVC mounting canister

- 700mA constant current remote driver
- Plug-In 12 Volt AC integral driver
- Hexcell louvre available



# MODUX TWO & FOUR

## LOUVRE+LARGE LOUVRE



Modux Two & Four Square, Stainless Steel

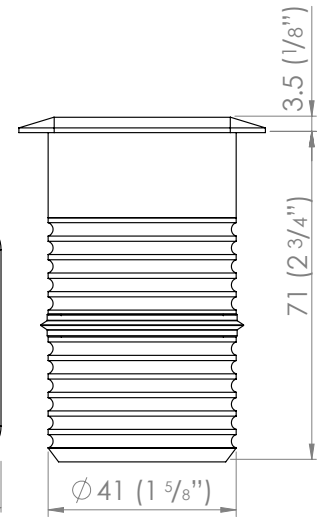
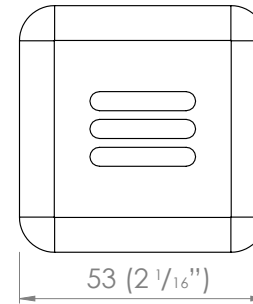

Modux Two & Four Large Square, Stainless Steel

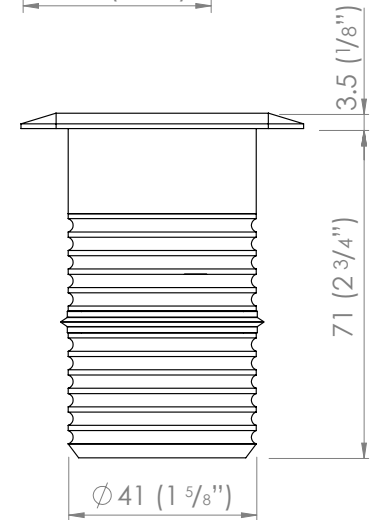
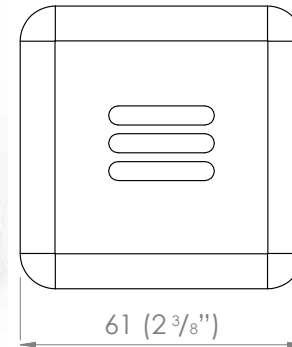

This Louvre model shields the light at a 45° angle to eliminate glare. Intended for step or wall illumination. Now available in a larger format flange style to better cover to better cover difficult mounting scenarios.

### Accessories:

- 50mm diameter PVC mounting canister
- 700mA constant current remote driver
- Plug-In 12 Volt AC integral driver

*\* Louvre is supplied with a frosted lens and 74 degree wide beam only.*





# MODUX TWO & FOUR

## STEP+STEP WITH SLOT



Modux Two & Four Step, Stainless Steel

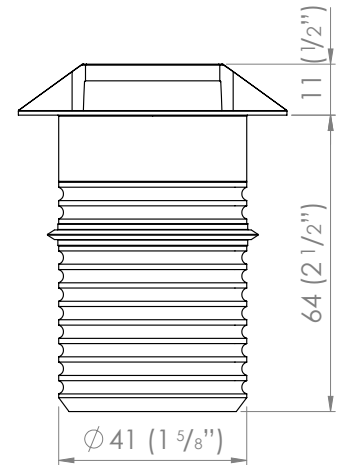
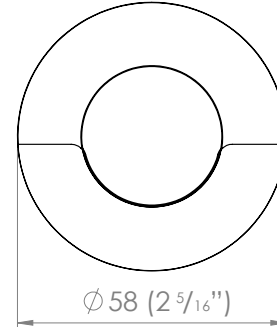

Modux Two & Four Step with Slot, Stainless Steel

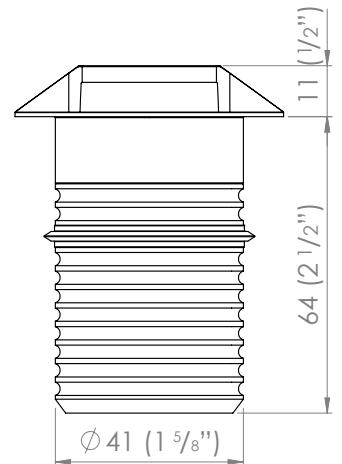
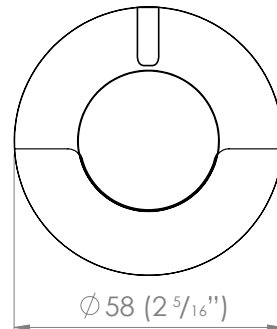

The Modux Two & Four recessed Steplight models are designed to be mounted in the ground to illuminate paths, or wash walls and steps. They feature a glass optic that orients light 5° below the horizon and 10° above. These offer extremely low glare in almost all applications.

### Accessories:

- 50mm diameter PVC mounting canister
- 700mA constant current remote driver
- Plug-In 12 Volt AC integral driver



# MODUX TWO & FOUR

## PATH+SQUARELIGHT RECESSED



Modux Two & Four Path, Stainless Steel



Modux Two & Four Squarelight, Aluminium

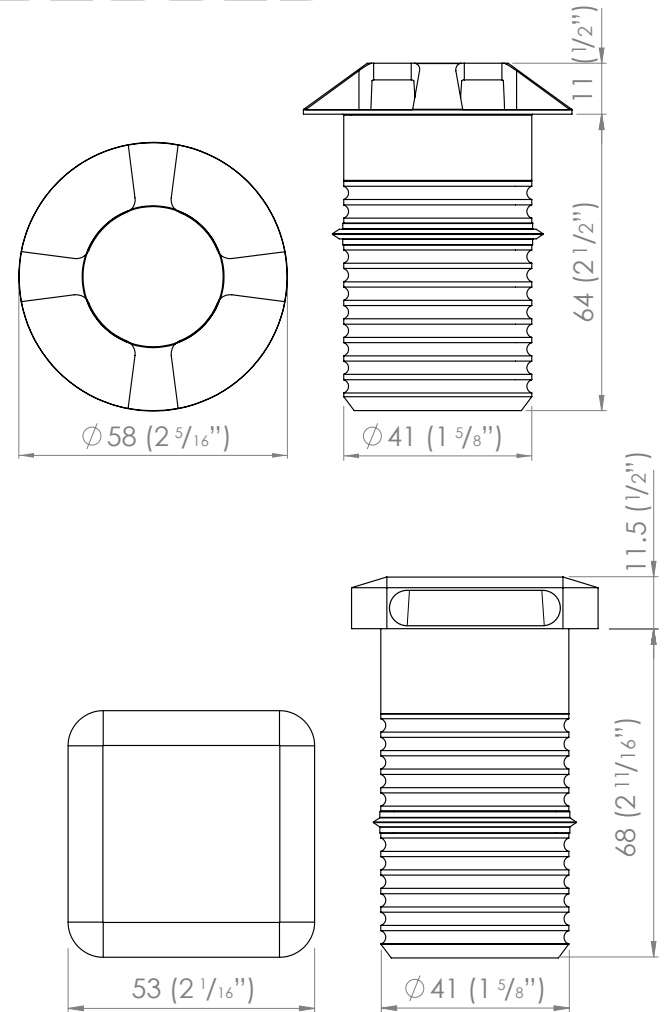

The Modux Two & Four recessed Pathlight and Squarelight models are designed to be mounted in the ground to illuminate paths, and wash walls. They feature a glass optic that orients light 5° below the horizon and 10° above.

These offer extremely low glare in almost all applications. Custom Path flange apertures available by special request.

### Accessories:

- 50mm PVC mounting canister
- 700mA constant current remote driver
- Plug-In 12 Volt AC integral driver



# MODUX TWO & FOUR SECURITY CANISTER



Modux Two & Four Step, Stainless Steel

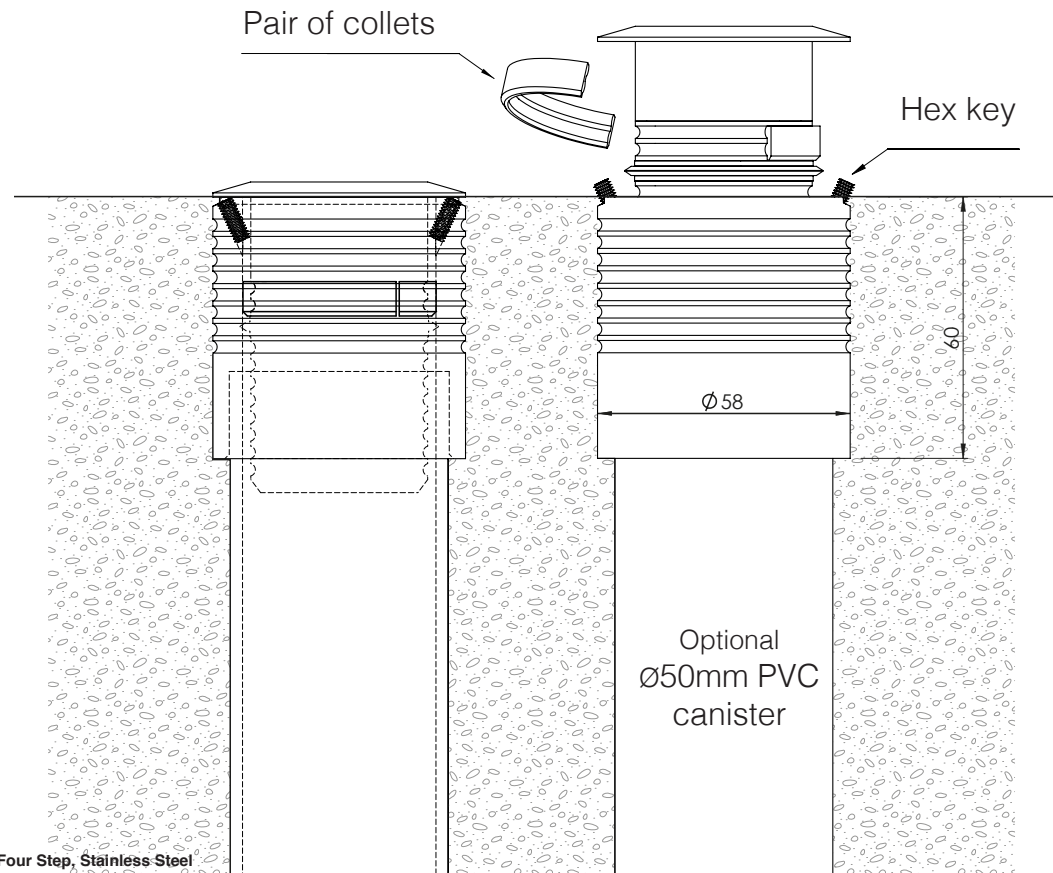

The Modux Two & Four recessed Security Canister is constructed of PVC. The canister is to be cast or resin bonded into the ground or wall, and is completely concealed by the luminaire's round flange.

PVC retaining collets prevent the luminaire from being removed fully unless the two stainless steel set-screws are extracted. The Modux body lip seal prevents water ingress.

Suitable for Modux 2 & 4 models:

- Round, Square, Louvre
- Large Round, Square, Louvre
- Step, Path, Squarelight

Accessories:

- 50mm diameter PVC mounting sub-canister



Modux Step , Stainless steel



Modux Path , Copper

SPOT+WEIGHTY BASE+BRACKET+SPIKE



Modux Four spot on a weighty base, Stainless steel

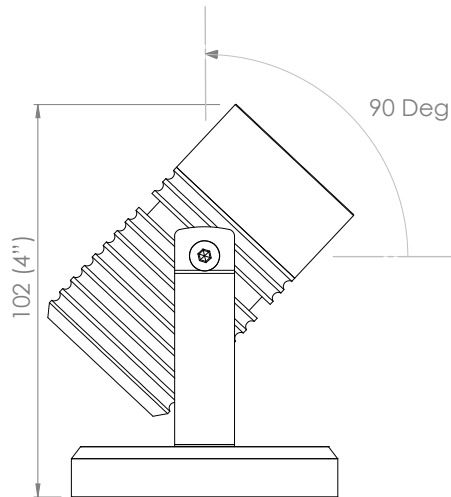

Modux Four Spot on a bracket, Stainless steel

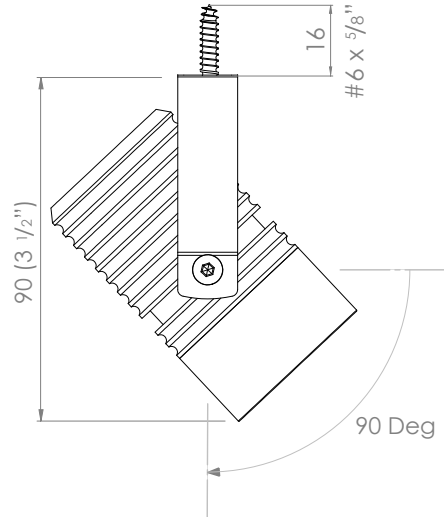

Modux Four spot on a Spike, Stainless steel

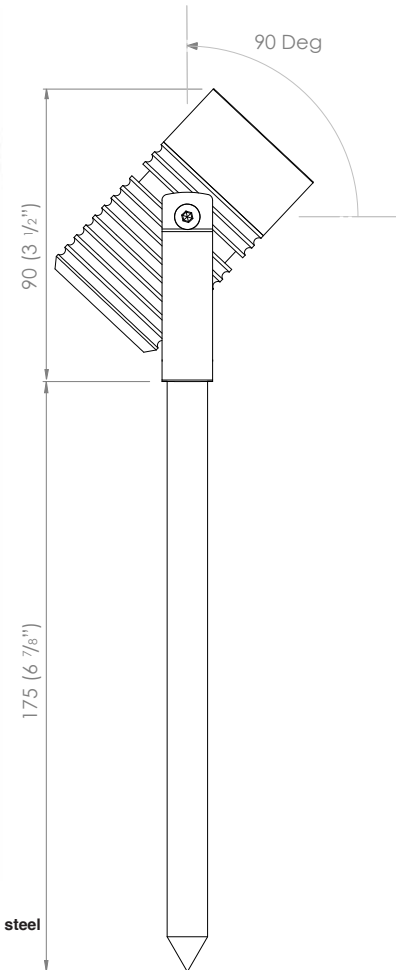

Modux Two & Four Spot flange is the basis for a pond light and a spike spot. These luminaires are mid-size spotlights with a swivel bracket that provides 90' elevation adjustment. The Pond has a weighted base and is designed to be installed underwater. The Spot can be

screw mounted to any hard surface and the Spike is designed to be inserted directly into the ground.

Accessories:

- 700mA constant current remote driver
- Plug-In 12 Volt AC integral driver
- Hexcell louvre available



## MODUX TWO & FOUR

# WALL+CEILING CANISTER

## GLARE GUARD



Modux Two Glare Guard on a Spike, Copper

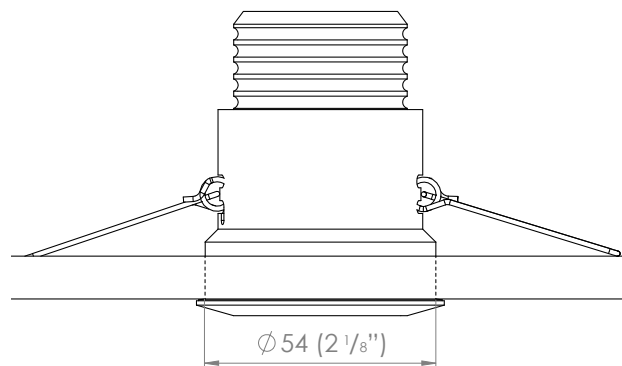

The Glare Guard can be adapted to any Modux Two & Four Spot, and Spike fitting. This can be used in combination with a Hexcell louvre baffle if required. The Glare Guard features a friction fit adjustable hood, and flush fitted glass to prevent water pooling.

Wall and ceiling mount spring canister for Modux Two & Four. Required cut-out is 54mm diameter. Note: This product is classed as an accessory.





# MODUX TWO CONFIGURATOR

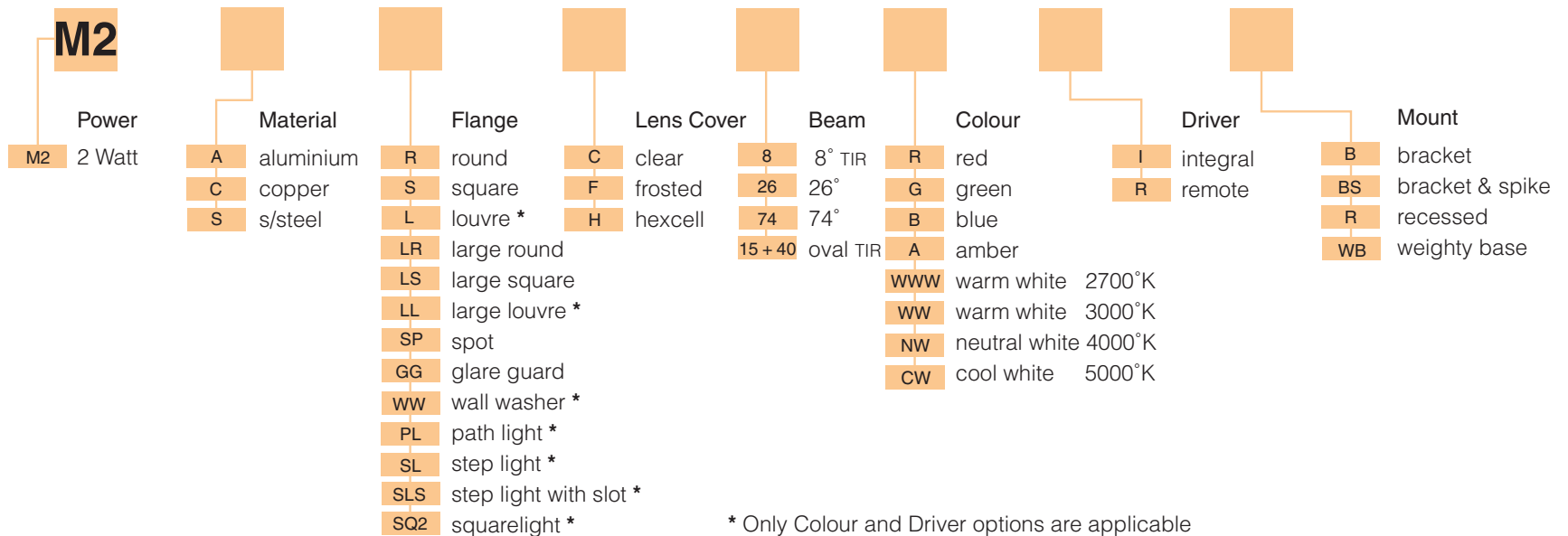

# MODUX FOUR CONFIGURATOR

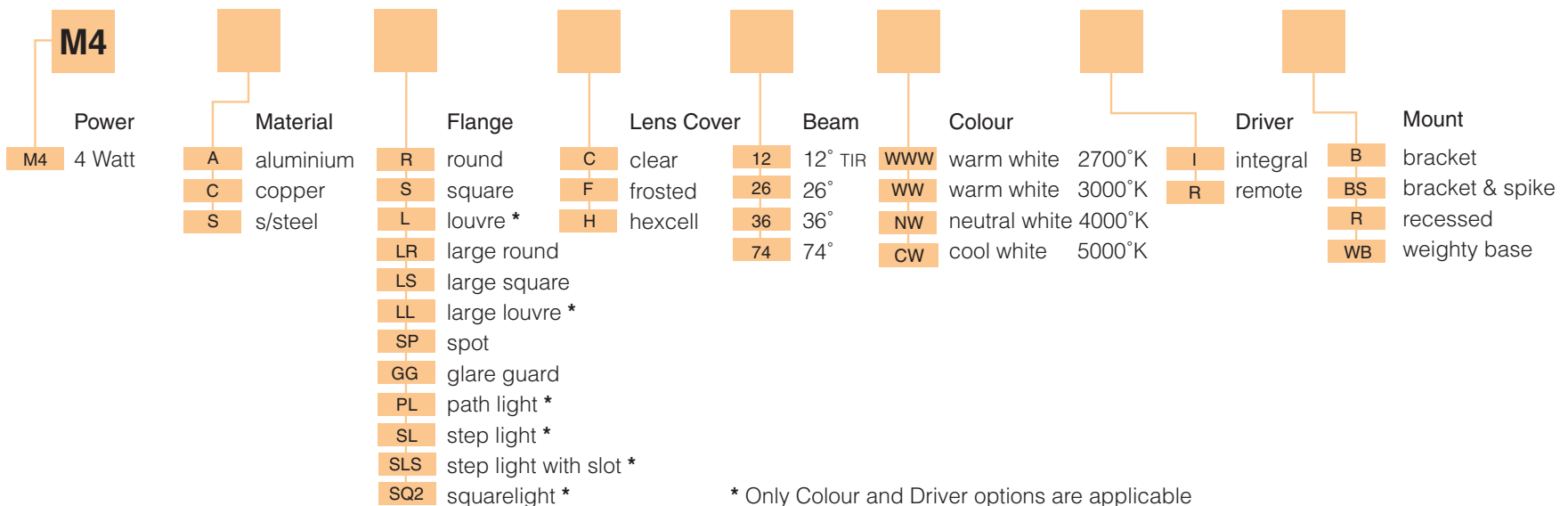

# MODUX V1

## Finishes



Natural Anodised Silver



White Powdercoated Passivated Aluminium



Black Powdercoated Passivated Aluminium

## Lens Cover



Frosted

## LED Colours



Warm White 2700°K



Warm White 3000°K



Neutral White 4000°K



Cool White 5000°K



Red



Green



Blue



Amber

## Beam



Wash



The LuxR Modux V1 Recessed Downlight is a small low-voltage dimmable indoor/outdoor light. Designed for recessing low down into walls to project an asymmetrical wash across paths and steps. It combines an ultra discreet profile without glare and an IP65 ingress protection rating. Three retaining options are available.

Specifications	
Power:	1 Watt @ 350mA
Input Current:	<500mA or less
Forward Voltage:	≈ 3V
CRI:	Ra 82
Luminaire Efficacy:	72 Lm/W @ 350mA
Luminaire Options:	Round recessed, Square recessed, Pond, Spot, Spike
Standards:	IP65, LM79, CE,
Light Engine:	Replaceable dimmable module equipped with the Cree® XT-E LED
Driver:	External constant current driver required.

# V1 SPRING+CLIP

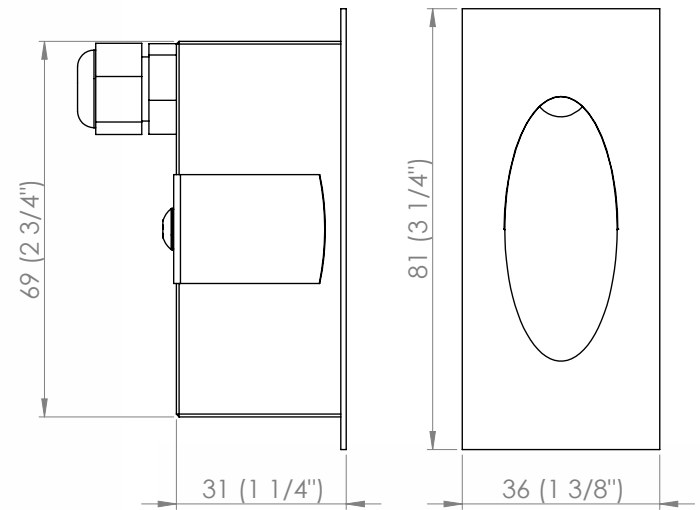

Precision machined from aluminium the V1 is available in natural anodised satin silver, or in E-Coat matte powdercoat colours. Ask your local agent for details.

The spring clips and leaf clip are made in marine grade 316 stainless steel for longevity.

Optional 316 stainless steel canister dimensions: L=80 x W=28 x H=74mm with 20mm cable entry hole.



# ORDERING

## V1 CONFIGURATOR

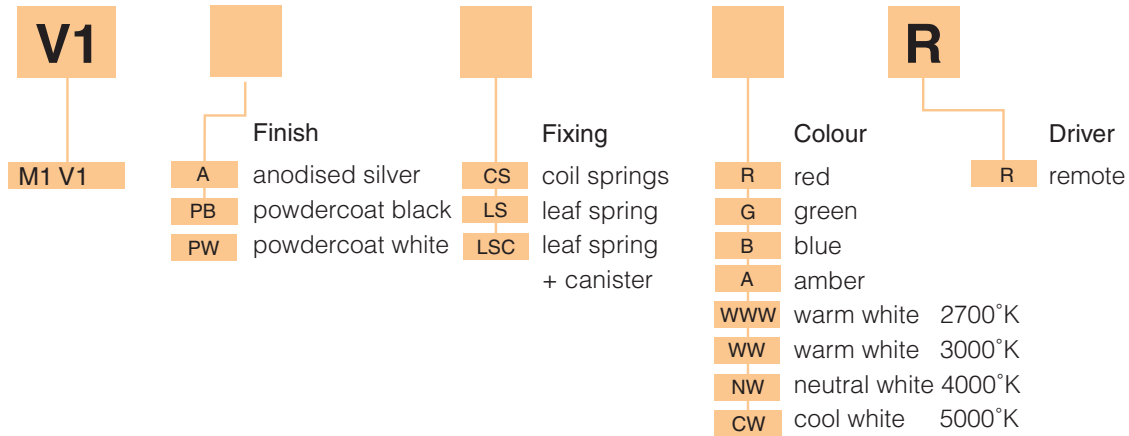

---

---

---

---

---

---

---

---

---

---

### CONFIGURATOR WORKED EXAMPLE

**V1** **A** **LSC** **WW** **R**

e.g. V1 . Anodised silver . Spot flange . Clear lens, 10° beam . 3000°K . Remote driver . Bracket + spike



# ACCESSORIES

## CANISTERS



Modux 1 : Ø 40mm x 200mm  
 Modux 2 : Ø 50mm x 200mm  
 Modux 4 : Ø 50mm x 200mm

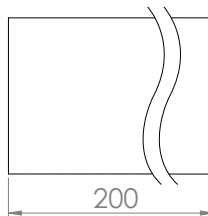
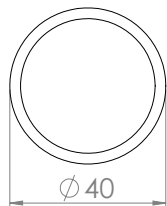
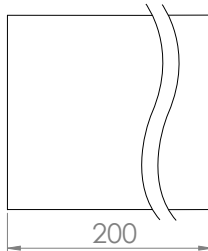
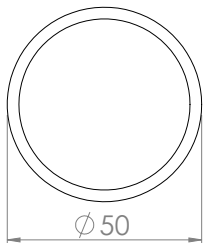

## INTEGRAL DRIVER



Modux 2 & 4 Integral driver module

Input Power: 12 VAC  
 (12VAC, 12-24VDC available Q1, 2016)  
 Output Current: 700 mA  
 Output Power: 4 W

## REMOTE DRIVER



LUXR-MP15 remote driver

Input Power: 240 VAC  
 Output Current: 60-360mA  
 Output Power: 1-15 W

LUXR-CLK Remote drivers

Input Power: 240 VAC  
 Output Current: 700/1050mA  
 Output Power: 2-10 W

### Recessed Mounting Canisters

LuxR PVC mounting canisters simplify the installation of Modux recessed luminaires. Designed to be mounted in the wall or ground. The luminaire is easily pushed inside the canister and is held in place with its silicon rubber lip seal. Not UL approved for North America.

### Integral Driver

LuxR offers an integral UL approved 700mA 12V AC phase dimmable driver for the Modux Two & Four models, enabling the luminaire to be easily connected to an approved 12 volt AC remote transformer. New improved version to be released Q1, 2016.

### Remote Driver

LuxR offers a small range of external remote drivers perfectly suited for Modux power supply requirements. LuxR remote drivers allow several luminaires to be connected to a single remote driver using SERIES WIRING. If you are not completely familiar with series wiring procedures please be sure to check with your distributor or a qualified LED installer.

# ENVIRONMENT

LuxR is committed to creating premium-quality, contemporary LED luminaires that will endure the test of changing tastes and trends, while keeping pace with constant advances in lighting technology.

We believe that the building industry must play an important role in reducing the negative impact of construction activity and, at the same time, assist people to realise their desires for increasingly improved living and work environments.

LuxR delivers on that belief by designing lighting solutions that are contemporary, effective, long lasting, and that help our customers to minimise the waste of resources.

- LuxR products are easily disassembled and all parts are recyclable.
- We minimise the number of different types of material used in each product for simplified recycling
- We do not use environmentally harmful coatings, such as chrome plating.
- All our metal selections are easily recyclable.
- Our copper products have a natural “living” finish, developing a patina that evolves over time. We can offer an accelerated patina aged-finish on request.
- Our aim is to source as many materials and processors as possible from within a 20 kilometre radius of our manufacturing plant in Auckland, New Zealand.
- Our packaging is made primarily of paper derived materials, including as much post-consumer recycled content as commercially possible.
- LuxR will continue to explore options for further reducing the environmental impact of our manufacturing processes.



# INSTALLATION

To preserve the validity of your warranty and ensure the long term performance of your LuxR products, it is critical to follow the correct installation procedures

Your distributor will be happy to provide you with advice and any additional information you may need.

Please note these important tips:

- When the device has been switched off, there is some temporary voltage remaining on the secondary output, which decomposes within about 10 minutes. At this stage, no LEDs may be connected.

In Order to remove the residual voltage, short circuit the contacts on the secondary output with the driver turned off.

- An LED can be damaged in an instant, and this may not be immediately obvious, therefore it is important to plan and check your install before you start.
- Remote drivers most commonly use SERIES WIRING, in which the LED luminaires are connected in a chain. If you are not completely familiar with series wiring procedures please be sure to check with your distributor or a qualified LED installer.

# CARE + REFINISHING

LuxR recommends the following cleaning methods only:

If you're unsure of what finish you have for any reason, please get in touch and supply some images.

Do not use oven cleaner under any circumstances

## *Black finishes*

Black powdercoat, Black anodising, black 316 stainless steel e.g. fasteners:

Wipe over gently with a damp soft cloth or chamois and a non abrasive cleaner.

Do not use metal polishing compounds like Brasso<sup>1</sup>, Autosol<sup>2</sup> etc

## *Stainless Steel*

316 marine grade stainless steel bodies and silver fasteners:

Scrub with a nylon brush, detergent and water.

Specialist stainless steel brightening gels are available but be aware that they are highly corrosive to other surfaces.

## *Living Finishes*

Natural copper body components: It is not essential that these finishes are cleaned as they will continue to patina over time

Wipe over with a damp soft cloth or chamois with detergent and water. When dry, a liquid furniture creme polish such as Neopol<sup>3</sup> or Pledge Shine-Up<sup>4</sup> can be applied, and the excess wiped off, which will even out and darken the natural patina slightly.

Do not use metal polishing compounds like Brasso, Autosol etc

## *Refinishing*

Refinishing is a straightforward process for all, except black finishes.

Contact LuxR to discuss in detail.

<sup>1</sup> Brasso is a trademark of Reckitt Benckiser Plc (UK)

<sup>2</sup> Autosol is a trademark of Autosol LLC (USA)

<sup>3</sup> Neopol is a trademark of Bushland Products Pty Ltd (AUS)

<sup>4</sup> Pledge Shine-Up is a trademarks of S. C. Johnson & Son (USA) It is also known as Pronto, Pliz and Blem

# WARRANTY

The LuxR Confidence Warranty overview:

LuxR products are manufactured from the highest quality materials and are designed to provide many years of reliable service when correctly installed. Our modular construction ensures that all components, including the LED Board and Internal Driver, can be easily disassembled for maintenance.

Our confidence in the quality of our products is demonstrated by the comprehensive warranty that comes with all LuxR luminaires:

## *Confidence Body Warranty*

Copper and stainless steel body and flanges on all LuxR Modux luminaires have a 10 year warranty against defective workmanship and deterioration while the aluminium body and flanges have a 5 year warranty. Both warranties are subject to standard conditions listed below:

## *Confidence Electronics Warranty*

The electronic components in all LuxR Modux luminaires have a 5 year warranty against defective workmanship and failure, subject to standard conditions listed below:

### Standard Conditions:

- The environment in which the fixture is to be installed must be considered carefully when selecting the finish. Solid copper and stainless steel fixtures are recommended for corrosive environments such as near salt water. Aluminium fixtures may not be covered by the full warranty in these situations.
- Stainless Steel requires regular cleaning in salt air environments.
- Warranty excludes impact damage (except for lenses), incorrect installation and incorrect re-assembly. Fixtures must be kept properly maintained, including replacement of gaskets whenever they are serviced.
- LuxR reserves the right to replace components or provide remedial repair service in certain situations where appropriate. These situations may include the following:
  - Minor problems, directly attributable to manufacturing defects, which are easily fixed in-field.
  - Installations where removal of the fixtures is not practically feasible.
- LuxR Limited reserves the right to limit liability on nonstandard fixtures or delivery arrangements.

**NOTES**



---

---

---

---

---

---

---

---

---

---

---

---

Proudly made in New Zealand

[www.luxrled.com](http://www.luxrled.com)

LuxR Limited Head Office  
130 Felton Matthew Avenue  
Glen Innes, 1072 , Auckland  
New Zealand

email [sales@luxrled.com](mailto:sales@luxrled.com)

